

6970938 Specification

Date:2018-10-19

No:001

Product Name		Factory Part No.	Customer Part No.	
RPDU		RC018C1653	LAN30064	
Main Functions		Details		
Monitor	Input	Input current (Amps)		
		Input Voltage (Volts)		
		Total energy consumption (kWh) for each phase		
		Total power(kW) for each phase		
		Power Factor		
	Output	On/Off status of circuit breaker		
		The current (Amps) / Energy (kWh) and power (kW) of circuit breakers		
	Environment	Cabinet temperature/humidity monitoring at 2 spots		
		External sensors	ON/OFF status of door contact	
			ON/OFF status of electronic locking swing handle	
			Smoke detector	
			Water leak detector	
	Cabinet LED light control			
	Control	Output	Switch on/off individual outlet	
Threshold settings	Input/output	Threshold settings of input current/voltage for each phase		
		Return to zero settings for total energy		
	System	Threshold of temperature/humidity settings		
		Master / Slave mode settings (1 Master max with 4 slave)		
		Quick set-up and back up		
		E-mail alarm notification		
		Network configuration		
	Wi-Fi settings			
	User management	User access permission settings		
		Outlet access permission settings		
Energy return to zero permission settings				
Alarm	Alarm type	Low/high voltage alarm		
		Overload or near overload alarm for input current		
	Alarm method	LCD displays the alarm and buzzer sounds		
		Web interface show the value exceeded in red		
		Send E-mail to administrator automatically		
		SNMP sends trap alarm information		
		Logical port outputs level signal		
Accessing method		Web based, support multiple browsers like IE, Google, Firefox etc.		
		SNMP (V1/V2C/V3)		

RPDU Specification

	Telnet, Modbus					
Logs	Input voltage, input current and output current alarm					
	Temperature /humidity alarm					
	Temperature/Humidity data					
	User log-in operation, Setting & configuration					
	Create new user, Delete user					
	Switch on/off/reboot					
	Log of input current data over a specific period of time					
	Log of Energy consumption data over a specific period of time					
	Multi-user operation system, compatible with various browsers					
	Export the logs			Word, Excel, Graph		
System	Keep the former on/off	Individual outlet				
	state after reset	Outlet groups				
	Support remote and batch upgrade					
	Multi-user with different level of user access accounts					
	HTTP, HTTPS, SSL, Telnet, TCP, SNMP v1/v2/v3, IPv4, DHCP, UDP,					
	SSH, DNS, SMTP, SMTPS, NTP Radius, Syslog					
	Support mass deployment, centralized management, group configuration and upgrade					
Input/output						
Input	Rated input voltage	400V~ 50/60 Hz				
	Input terminal type	IEC60309 32A (3P+N+E) plug				
	Cable specification	5×6.0mm ² ;				
	Cable length	3M				
	The max input current	3x32A				
	Overload protector	3x32A circuit breaker				
Output	Socket	IEC320C13+ LED	Rated current	10A	Outlet quantity	16
	Rated output voltage		250VAC			
Dimension	Product size	L×W×H =1830×66×52mm				
Optional fittings						
Temperature/humidity sensor						
Design: Linda	Customer confirm:	Check:		Authorized:		

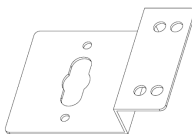
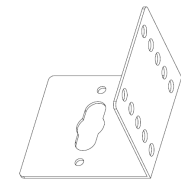
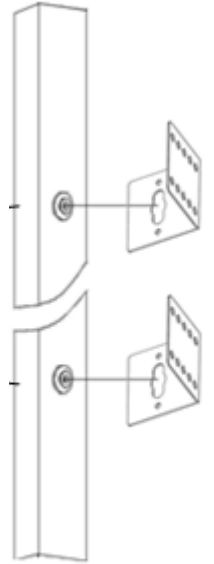
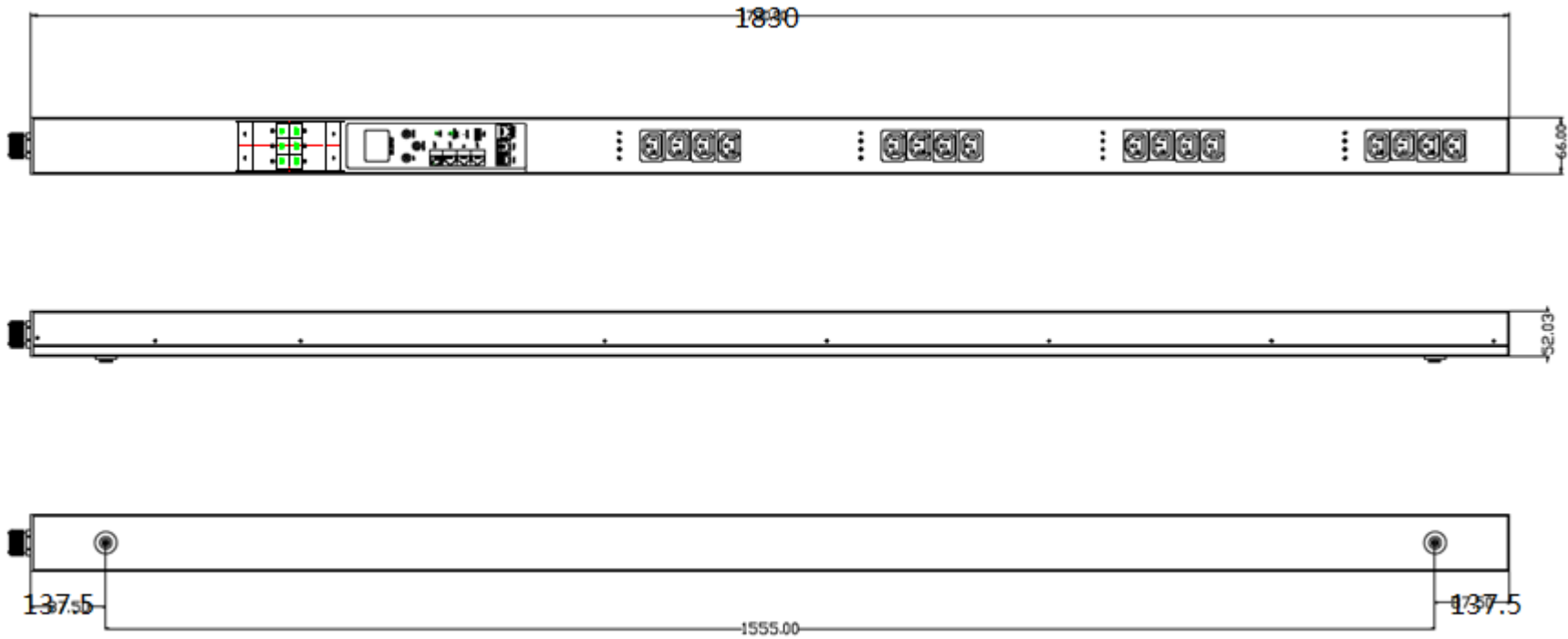

IEC 60309 32A (3P+N+E) plug