

## Say Goodbye to Cage Nuts

Meet the revolutionary new Rackstuds™

[Play the Rackstuds™ video >](#)



**RACK  
STUDS™**  
The smart rack mounting system

Rackstuds™ are the revolutionary replacement for the cage nut used to mount IT, Pro A/V, Security, Telecommunications in 19" racks.



EASY

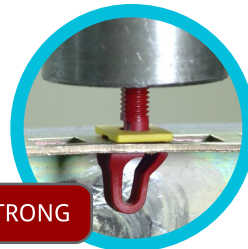

STRONG



SAFE

### **Rackstuds™ are Easy!**

Unlike cage nuts, Rackstuds™ go in from the front which greatly simplifies their installation. They install in seconds and provide you with a place to hang your gear while you spin on the nut, all without tools.

### **Rackstuds™ are Strong!**

Independently tested to over 156kgs/343lbs of shear strength, there's no doubting they're a suitable replacement for the cage nut.

### **Rackstuds™ are Safe!**

Rackstuds™ are made from a 'metal replacement' engineered plastic so they won't pose an electrical threat for you or your gear. They won't scratch your equipment either!

## Rackstuds™ vs. Cage Nuts



- Tool free
- No more cut hands!
- Easy to mount even heavy gear
- Go in from the front - super fast

## Say Goodbye to Cage Nuts

Meet the revolutionary new Rackstuds™

Play the Rackstuds™ video >

## Tips and Tricks

1. You must ensure you locate the correct position for the start of the 'RU' section. The holes are grouped in three's starting with a thin steel section and then two thicker sections. The hole below the thin section denotes the start of the RU spacing for 1 rack unit. Some racks have 'RU' markers which make this much easier.
2. With smaller holes, you need to get the lip shown in image 2 behind the rail first. This is best achieved while tightly compressing the spring section and by pushing the stud in at 45°.

## How to insert the Rackstuds™

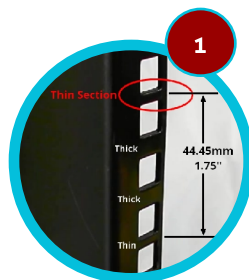

1. Ensure you locate the start of the 'RU' section indicated by the thin steel section above the hole.

See [http://en.wikipedia.org/wiki/Rack\\_unit](http://en.wikipedia.org/wiki/Rack_unit)

2. Insert the stud **sideways** with the spring section towards the centre of the rack. The lip (highlighted) needs to go in past the rail first.

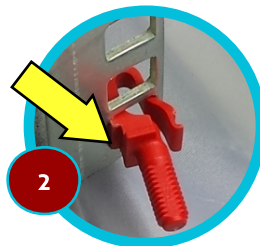

3. While tightly compressing the spring section, insert the Rackstuds™ at 45° until the lip drops in behind the rail.

4. With the spring section still compressed, pull the front towards the centre of the rack and push the back in the opposite direction.

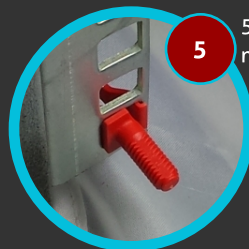
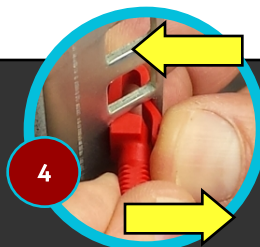

5. Click the spring into the rail section. You may need to push on the tab until you hear it click.

6. Insert the yellow lock washer (sideways) until it mates with the stud. It will only go on one way. You're now ready to mount your gear!

